



# SOUTH PARK

LIVING ON WHYTE

Whyte (82) Avenue NW and 106 Street NW  
Edmonton, AB

[southparkonwhyte.com](http://southparkonwhyte.com)

 **WHEATON**  
PROPERTIES

  
one properties



# Southpark on Whyte

Whyte (82) Avenue NW and 106 Street NW, Edmonton, AB | [southparkonwhyte.com](http://southparkonwhyte.com)



Located on Whyte Avenue and in Edmonton’s popular and lively neighbourhood of Old Strathcona, Southpark on Whyte will be a draw for consumers across the city along with workers and students in the university area. The Whyte Avenue district offers an eclectic mix of retail, entertainment, and shopping like no other. Businesses within one of Canada’s five best shopping neighbourhoods includes a variety of local boutique shops, services, art galleries, trendy restaurants and cafes, and more. Southpark on Whyte is surrounded by densely-populated residential areas that are located within a few blocks from the 40,000-student University of Alberta, one of the top 5 universities in Canada. Old Strathcona is also known for hosting art and culture celebrations and festivals, and is home to the 130-vendor indoor farmers market.

The project will be developed in four phases with Phase 1 featuring Whyte Avenue-facing ground floor retail units (ranging from 1,100 sq. ft. to 3,400 sq. ft.) totalling 15,900 sq. ft. with a 99-unit rental apartment above (approx. 150 residents). Upon completion, there will be a total of 660 residential suites (approx. 1,000 residents) and 26,900 sq. ft. of retail space.

## SIZE (NLA)

Total Retail (Ground Floor).....	26,100 sq. ft.
Phase 1.....	15,900 sq. ft.

## OPENING

Phase 1 Occupancies.....	Immediate
Phase 2 Construction.....	Future
Phase 3 Construction.....	Future
Phase 4 Construction.....	Future

## TRADE AREA

	2020 ESTIMATE	2025 PROJECTION	2030 PROJECTION
Within 1 km	13,690	16,042	18,290
Within 3 km	86,745	101,152	114,211
Within 5 km	197,611	222,986	246,443

**WATCH VIDEO**  
[oneproperties.com/southpark](http://oneproperties.com/southpark)





# Southpark on Whyte

Whyte (82) Avenue NW and 106 Street NW, Edmonton, AB | southparkonwhyte.com

WHYTE (82) AVE NW

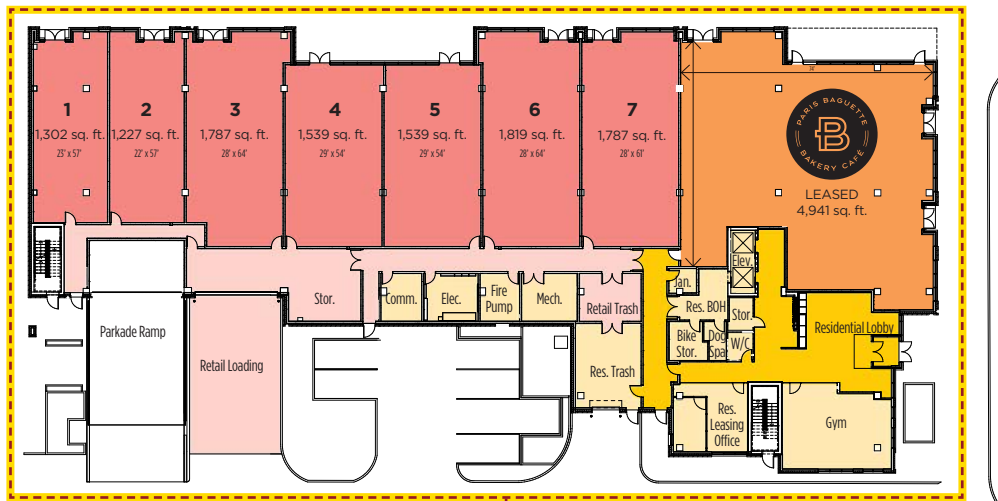

PHASE 1

LANEWAY

106 ST NW



- Retail
- Leased Retail
- Retail Services
- Residential
- Residential Services



# Southpark on Whyte

Whyte (82) Avenue NW and 106 Street NW, Edmonton, AB | [southparkonwhyte.com](http://southparkonwhyte.com)





one properties

## LEASING CONTACT

### **ROBERT MULVALE**

Vice President, Retail Leasing

**Desk:** 647.256.1017    **Cell:** 416.949.9112

**E-mail:** [rmulvale@oneproperties.com](mailto:rmulvale@oneproperties.com)

[oneproperties.com](http://oneproperties.com)